

RIVELLE

TAMPINES STREET 95, DISTRICT 18

Rivelle Tampines

572-unit Tampines EC with 3- to 5-bedroom homes near Tampines West MRT and Bedok Reservoir.

572

UNITS

D18

DISTRICT

EC

TYPE

30 Jun 2030

VP

Tampines West

MRT

PROJECT FACTS

Project Name	Rivelle Tampines
Property Type	Executive Condominium
Address	51-71 Tampines Street 95, Singapore
District	18
Tenure	99 years from 5 February 2025
Developer	Sim Lian JV (Tampines 7) Pte. Ltd.
Total Units	572 units
Site Area	22,488.9 sqm / 242,068 sqft
Plot Ratio	2.5
TOP / VP	Expected vacant possession 30 June 2030

UNIT MIX

Type	Size	Units
3 Bedroom	883-926 sqft	241
4 Bedroom	1,044-1,184 sqft	291
5 Bedroom	1,378 sqft	40

KEY SELLING POINTS

- Executive Condominium supply in the mature Tampines estate.
- 5-minute walk stated to Tampines West MRT and the future Pinery Mall.
- All homes are family-sized 3- to 5-bedroom layouts.
- Sim Lian development and construction track record.

LOCATION & CONNECTIVITY

- 5 mins walk to Tampines West MRT
- 5 mins walk to future Pinery Mall
- 6 mins cycle to Tampines Round Market and Our Tampines Hub
- 5 MRT stops to Jewel Changi Airport

SCHOOLS NEARBY

St Hilda's Primary within 1km, Tampines Primary, Jun Yuan Primary, St Anthony's Canossian Primary, Temasek Polytechnic, SUTD

DEVELOPER & TEAM

Developer	Sim Lian JV (Tampines 7) Pte. Ltd.
Architect	ADDP Architects LLP
Landscape Architect	Ecoplan Asia Pte Ltd
Structural Engineer	BCK & Partners Pte Ltd
M&E Engineer	United Project Consultants Pte Ltd
Main Contractor	Sim Lian Construction Co. (Pte.) Ltd.

SITE / FLOOR PLAN PREVIEW

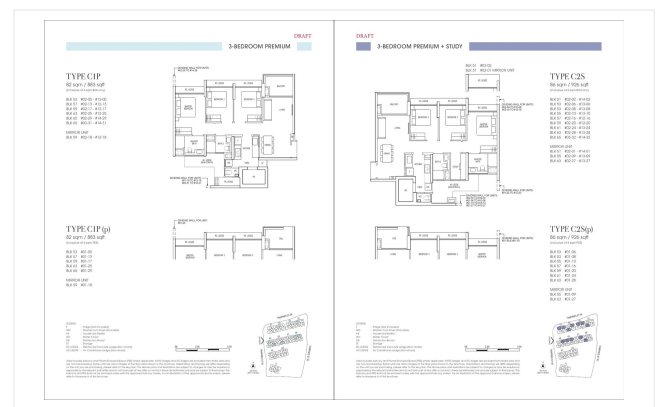

SUSTAINABILITY & SPECS

- EC family-sized planning supports owner-occupation
- 5 EV charging lots and accessible parking provided
- Landscape deck and waterscape concept
- Proximity to MRT, cycling routes and mature-town amenities